

# BUBBLE MASTER FDS PAIL

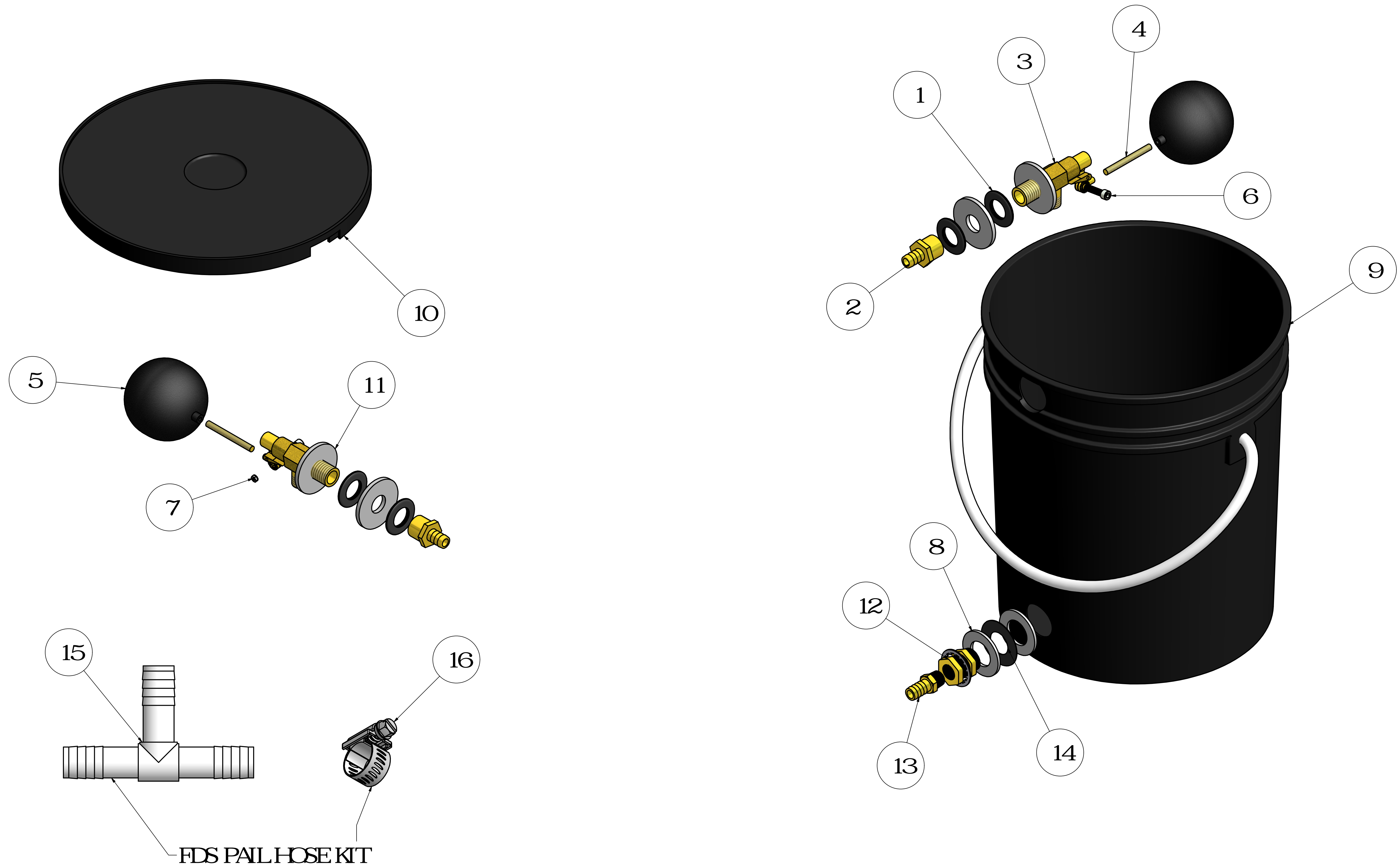

# BUBBLE MASTER FDS PAIL

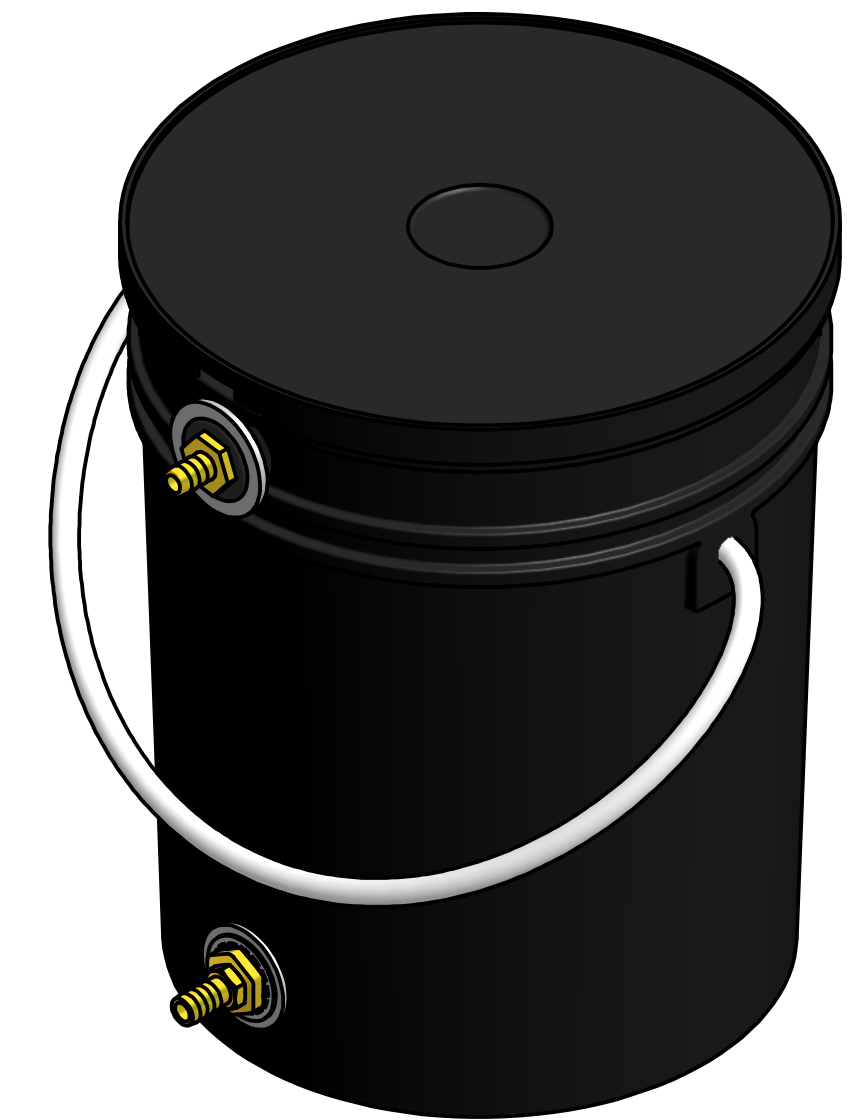

| PARTS LIST |     |              |                                  |
|------------|-----|--------------|----------------------------------|
| ITEM       | QTY | SALES NUMBER | DESCRIPTION                      |
| 1          | 1   |              | RUBBER GROMMET                   |
| 2          | 1   |              | 1/2 NPT FEMALE 1/2 BARB          |
| 3          | 1   | CXP 1107     | FDS PAIL 1/2' BRASS FLOAT VALVE  |
| 4          | 1   |              | 1/4 20 X 2.5' S.S. THREADED ROD  |
| 5          | 1   | CXP 1105     | FDS PAIL 5' FLOAT                |
| 6          | 1   |              | 1/4 20 X 1" SOCKETCAP SCREW S.S. |
| 7          | 1   |              | 1/4 KEPS NUT S.S.                |
| 8          | 2   |              | 1-1/8 ID X 2 OD S.S. WASHER      |
| 9          | 1   |              | 20L BLACK PLASTIC PAIL           |
| 10         | 1   |              | 20L PAIL PLASTIC LID BLACK       |
| 11         | 2   |              | 20MM WASHER S.S.                 |
| 12         | 1   |              | 3/8 NPT BULK HEAD                |
| 13         | 1   |              | 1/2 BARB X 3/8 NPT               |
| 14         | 1   |              | NEOPRENE GASKET FOR BUBBLE FDS   |
| 15         | 1   |              | PLASTIC 1/2 BARB TEE             |
| 16         | 4   |              | 3/4 HOSE CLAMP                   |

| REVISION HISTORY |            |
|------------------|------------|
| REV-#            | DATE       |
| A                | 19/12/2016 |